



RE/MAX
North



45 Bamford Street, Manchester, M11 4FE

Asking price £250,000



3



1



2



D



Asking price £250,000

45 Bamford Street

Manchester, M11 4FE

Situated on the popular Bamford Street in Clayton, Manchester, this extended semi-detached home offers generous living space and fantastic potential for buyers looking to create their ideal family home.

The ground floor provides a versatile and spacious layout, featuring a large living room, separate dining room, and an impressive multi-purpose kitchen/diner ideal for everyday family life and entertaining. A utility area and family bathroom add further practicality to the home. Upstairs, the property offers three well-proportioned bedrooms, a separate office/study perfect for remote working, and an additional WC.

The property also benefits from a connected garage, providing valuable storage or potential for further conversion.

While the home would benefit from some modernisation, it offers excellent scope to add value and personalise, making it a fantastic opportunity in a well-established residential location.

Located in Manchester, this home benefits from the vibrant culture and amenities the city has to offer, including shops, schools, and parks, all within easy reach. This property is ideal for those looking to settle in a lively area while enjoying the comforts of a spacious family home.

With its appealing features and prime location, this semi-detached house on Bamford Street is a wonderful opportunity not to be missed.



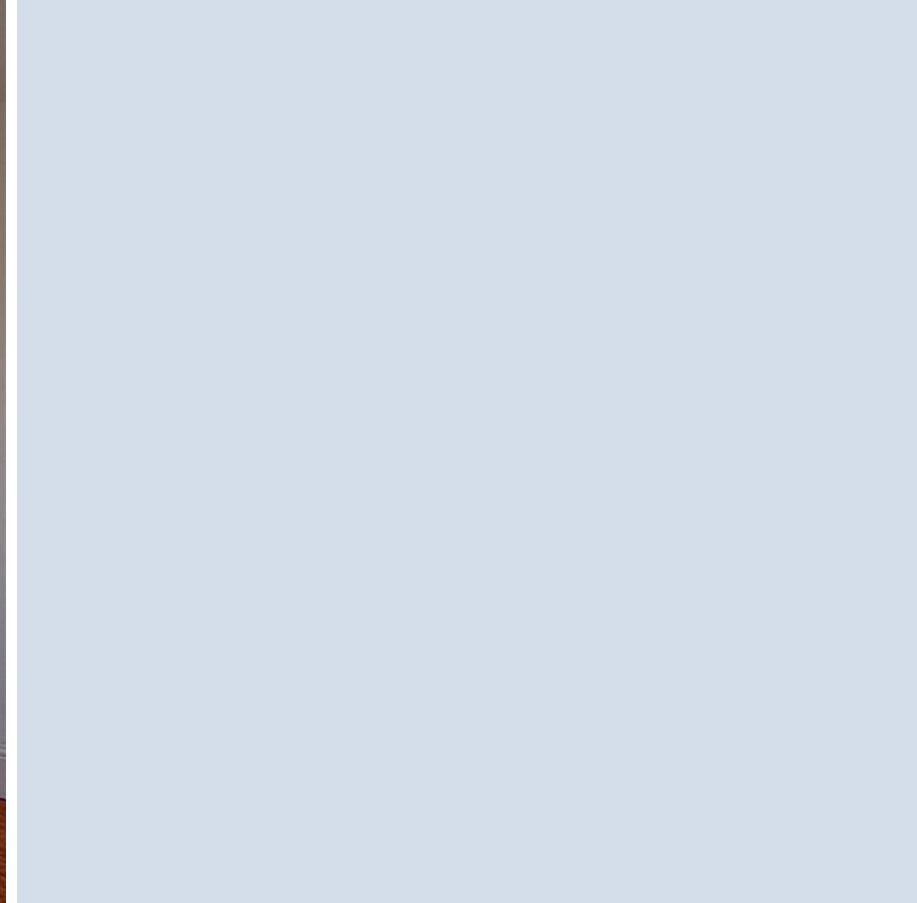



Floor Plans

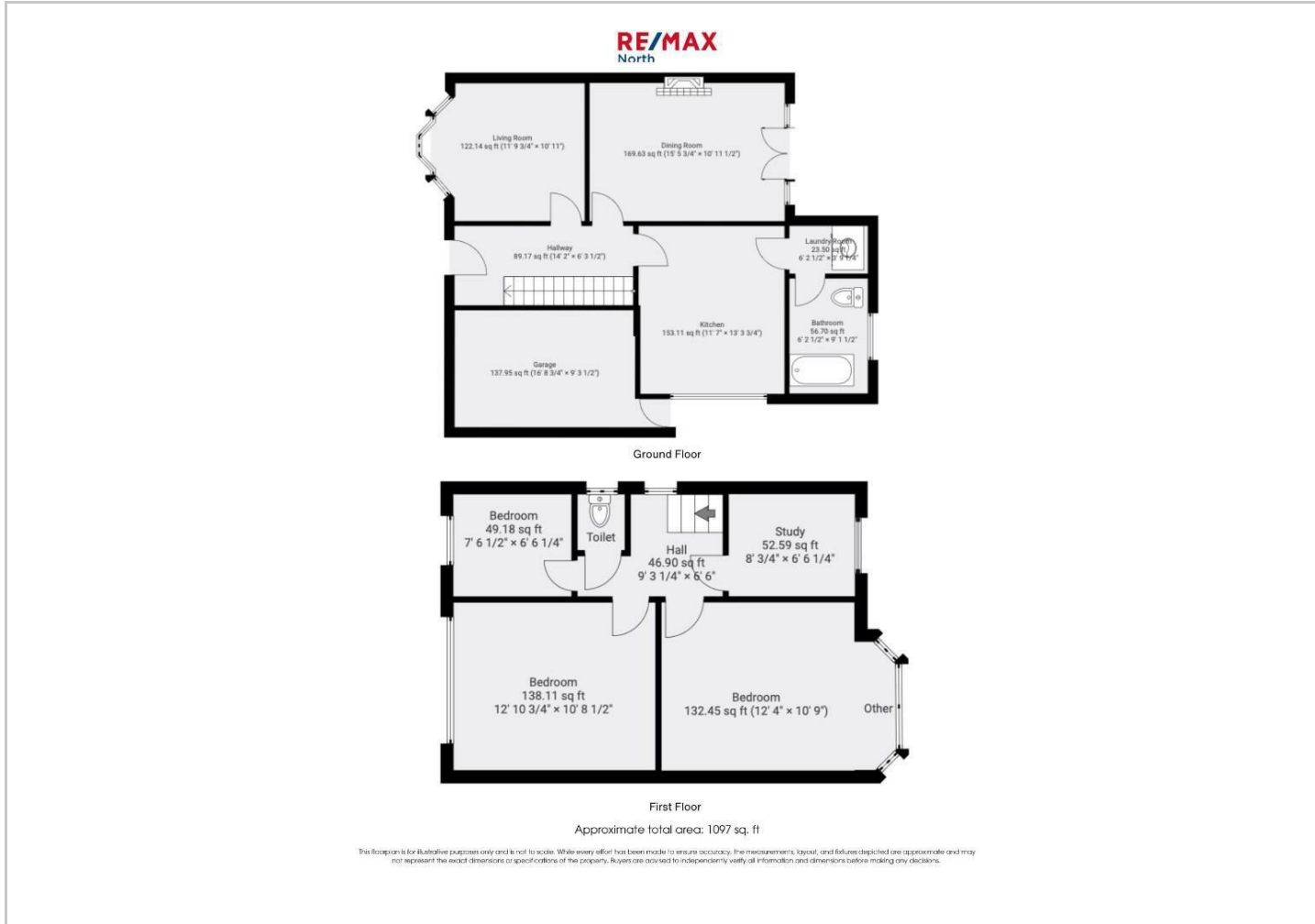

Viewing

Please contact our RE/MAX North Sales Office on +44 (0) 1618 040807 if you wish to arrange a viewing appointment for this property or require further information.

The particulars are set out as a general outline only for the guidance of intended purchasers or lessees, and do not constitute, any part of a contract. Nothing in these particulars shall be deemed to be a statement that the property is in good structural condition or otherwise nor that any of the services, appliances, equipment or facilities are in good working order. Purchasers should satisfy themselves of this prior to purchasing.

94 Phoebe Street, Salford, Greater Manchester, M5 3PH
 Tel: +44 (0) 1618 040807 Email: remax.north@remax.co.uk remax.co.uk

Location Map

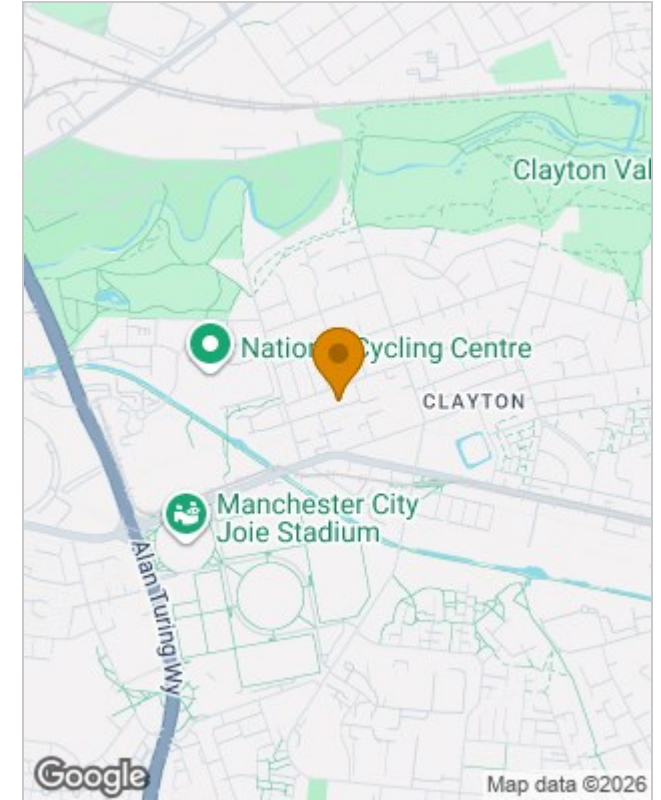

Energy Performance Graph

